

**RAK-COMPACT**  
Close Coupled | Water Closet

**RAK**  
CERAMICS

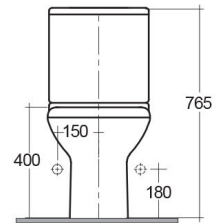
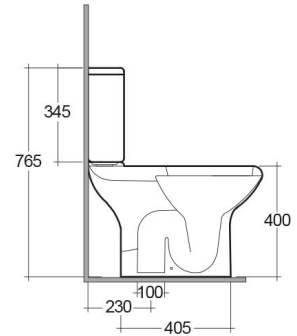
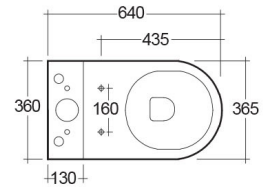

**TECHNICAL SPECIFICATIONS**

Suite:	RAK-COMPACT
Type:	Close Coupled
Dimensions:	640 x 365 mm
Weight:	34 Kg
Color:	Alpine White
Trap type:	S Trap
Trapway type:	Concealed
Seat cover options:	ABS & Urea
Bowl shape:	Round
Soft close:	yes
Flush Type:	Dual Flush

Code	Name
JM05DAWHA	SEAT & COVER (ABS)
CO03AWHA	COMPACT WATER CLOSET CLOSE COUPLED BACK OPEN S-TRAP 64CM
CO10AWHA	COMPACT WATER CLOSET TANK
JM05DSCQRAWHA	JUMEIRAH QRSC ABS seat
YFG173A	RAK-Compact Urea Soft Close Seat Cover

Dimensions: All dimensions in mm. Tolerance of vitreous china & fireclay items:  $\pm 5\%$  for below 200mm and  $\pm 3\%$  for above 200mm; for all other items tolerance  $\pm 1\%$ . Note: Due to a continuing development program to improve design and performance, the manufacturer reserves all rights to vary specifications without prior information. Please note accessories are for photographic use only.